

ANDREW YULE & COMPANY LIMITED

TEA DIVISION

NEW DOOARS TEA ESTATE

TENDER FORM FOR CONSTRUCTION OF DOUBLE UNIT LABOUR QUARTER WITH LATRINE AND HOUSE WIRING.

PART – A

Scope of Job :

The job consists of construction of 6 nos. Double Unit Labour Quarters with Latrines and House Wiring in the four Dooars gardens viz. Banarhat (1 unit), Karballa (2 units), New Dooars (2 units) and Choonabhutti (1 unit) Tea Estates. The entire job will be given on turn-key basis & the Contractor should complete the entire operation within the stipulated time frame & hand over the Quarters to the garden. **Tenderers should visit the gardens & physically check the areas where the Quarters/Latrines are to be constructed.**

Quotation need to be submitted in two parts. In **PART-A** commercial conditions & credentials need to be submitted. Those who fulfill the criteria mentioned in “Part A” shall only be eligible to participate in the financial bid which is detailed in PART-B.

Drawings are part of the tender and are given in Annexures I,II & III of Part A. Tenderers are advised to complete both the parts & put **PART-A & PART-B** in two separate sealed envelops superscribed with the words **“Tender for Double Unit Labour Quarter with Latrine & house wiring PART-A ” & “Tender for Double Unit Labour Quarter with Latrine & house wiring PART-B ”.** The two separate envelopes should then be put in one single envelop sealed & superscribed with the words **“Tender for Double Unit Labour Quarter with Latrine & house wiring PART-A & PART-B ”.** **The job may be split between more than one party & management’s decision in this regard shall be final & binding.** Any of the applications received may be rejected without assigning any reasons whatsoever. **Please attach Demand Draft of Rs.20,000/- (Rupees Twenty Thousand only) as Earnest Money Deposit in favour of “Andrew Yule & Co. Ltd., New Dooars Tea Estate” payable at Banarhat/Siliguri.**

The application needs to be addressed to :

The Manager
New Dooars Tea Estate
P.O.: Banarhat,
Dist.: Jalpaiguri, W.B.,
Pin.: 735202.

Contd.....Pg/2

The following conditions needs to be fulfilled before the applicant is eligible to quote.

(To be filled in by the applicant)

1. Full Name of the firm :
2. Full Postal address of the Firm :.....
With telephone number,
(Office & mobile), E-mail id
.....
3. A. Whether Registered under MSME (SSI) : Yes/No
(If Yes, please submit a photocopy)
- B. Whether Owned by SC/ST entrepreneur :
4. PAN Card Number with photocopy :
5. GST number with photocopy :
6. Trade Licence Number with photocopy :
7. Bank Account Number,
Name of the Bank with Branch & address
.....
.....
8. Bank certificate regarding
Normal operation of your Account :
9. The firm should have past experience Of Construction
of Double Unit Labour Quarter with Latrine &
House wiring for last 3 years in Tea Industry in Jalpaiguri/Siliguri area.
(Photocopy of past orders need to be submitted)
10. E. M. D : **Rs.20,000.00** Draft No.:.....
Date :.....
(Which shall be returned after successful completion of the job but shall be
forfeited if the project is abandoned midway except for any act of god/ riots/
any Govt. regulation/ Political Disturbance/ Disturbance due to Wild animals)

Tender Form : Rs.500/-, To be paid in Cash/DD while collecting from the garden. In case of downloads from web-site, it should be paid through Demand Draft to be attached with this form.

All Bankers Cheque/ Demand Drafts to be drawn in favour of **"Andrew Yule & Co. Ltd., New Dooars Tea Estate"** payable at Banarhat/Siliguri.

Contd.....Pg/3

TERMS & CONDITIONS

Page 3 of 6

1. Work is to be completed within **120 days** from the date of the order.
2. All rates quoted will remain fixed until the job is completed & NO Price revision will be allowed, for any reason, whatsoever.
3. Penalty clause shall be applicable if the job is not completed within the stipulated time in Purchase Order. Penalty will be 0.5% of Project Value for each week of delay from the scheduled date of completion, maximum of 5% of total project value.
4. Any delay or failure in the performance of either party hereto will not constitute default thereunder or give rise to any claim for damages, if any, to the extent such delays or failure of performance is caused by the concurrence such as acts of god, or the public enemy, appropriation or confiscation of facilities by Govt. Authorities, acts of war, rebellion or sabotage, fires, explosions, riots and illegal strike.
5. All the applicable labour laws relating to deployment of labourers/employees will be strictly followed in executing the contract.
6. No advance will be given. Part payment will be released on the basis of submission of actual bills subject to 10% retention at each stage which will be released after six months of successful completion of the project, if no dispute arises regarding quality of the project.
7. Bidding for each item is a must. Quotation submitted in incomplete form will be rejected.
8. Replacement of the defective/substandard material/job has to be made good within 15 days.
9. Management reserves the right of inspection at any time.
10. Management reserves the right to reject any or all quotations, without assigning any reason whatsoever.
11. The Quotations must include packing and delivery charges at the Garden and no collection of stores will be made from your go down unless specifically agreed to.
12. Please quote for only those Make and Brand as stated in the LIQ.
13. All alterations in the quotations must be attested by full signature.
14. Rates are to be inclusive of all applicable Taxes/GST unless otherwise specifically stated in your quotation.
15. Actual need based Order quantity may vary from the indicated quantity at the sole discretion of Garden Management.
16. The specifications can not be changed. A tender who is unable to supply the materials or work as per specification, may however give Quotations for alternative items but this must be done on a separate sheet of paper or letter head of the Firm with the words "See item in the enclosed sheet" in this form.
17. In the event of failure to make supply or correct supply within the stipulated period the Garden will be a liberty to make the purchase elsewhere and the tenderer shall be liable to make good any loss suffered by the garden as a result of such purchases.
18. Taxes will be deducted as per statute.
19. All Disputes are subject to Jalpaiguri jurisdiction only.
20. Quotation will be valid for 6 months from the date of opening.

Last date of submission of Tender : 2nd November, 2017.

Date & time of opening of the Tender : 3rd November, 2017, at 11 am.

I have read the tender papers & have understood the detailed process.

I agree to all the terms & conditions mentioned above.

Date :

Signature of the Party with Office Seal

Annexure - I

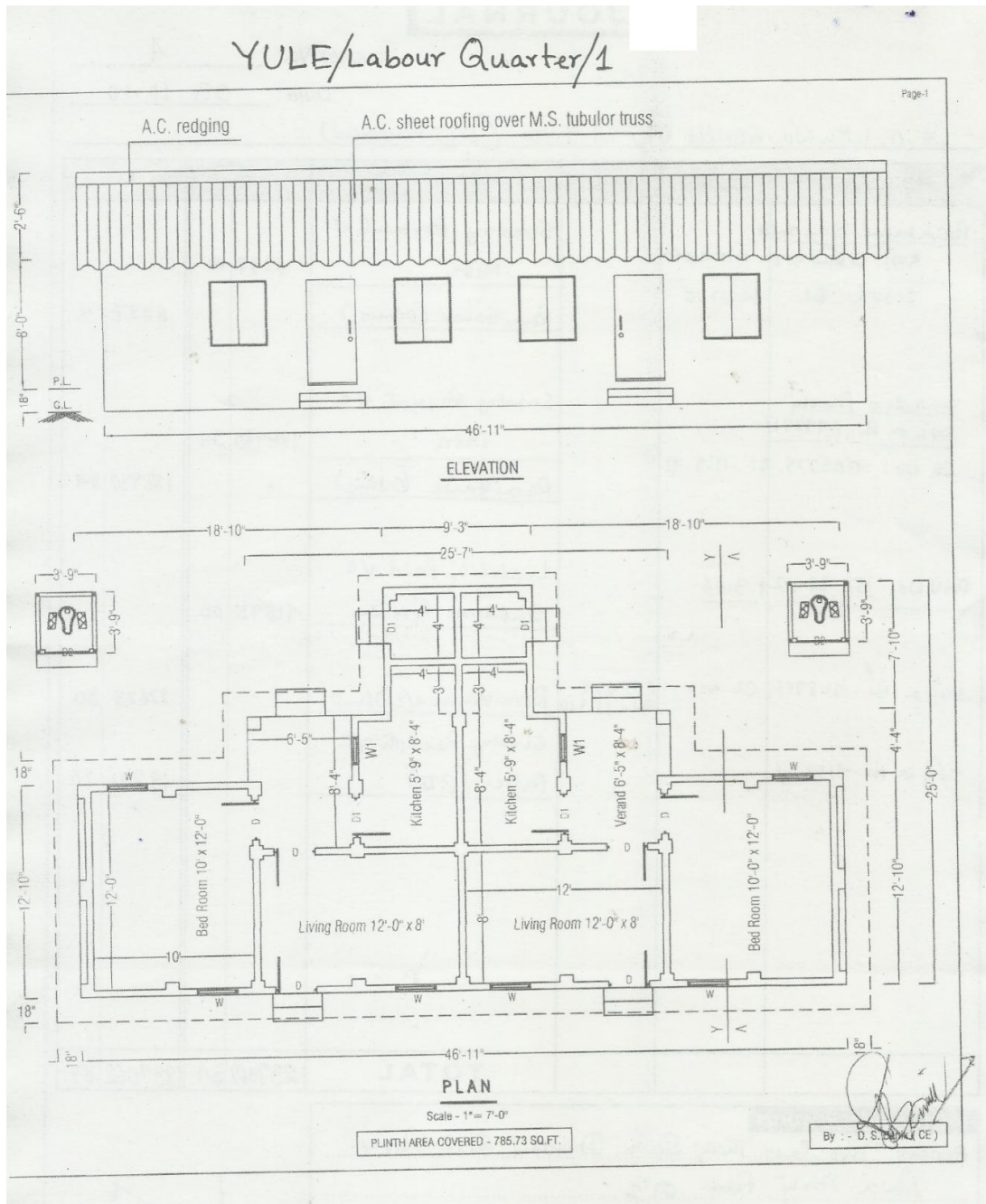

Date :

Signature of the Party with Office Seal

Annexure - II

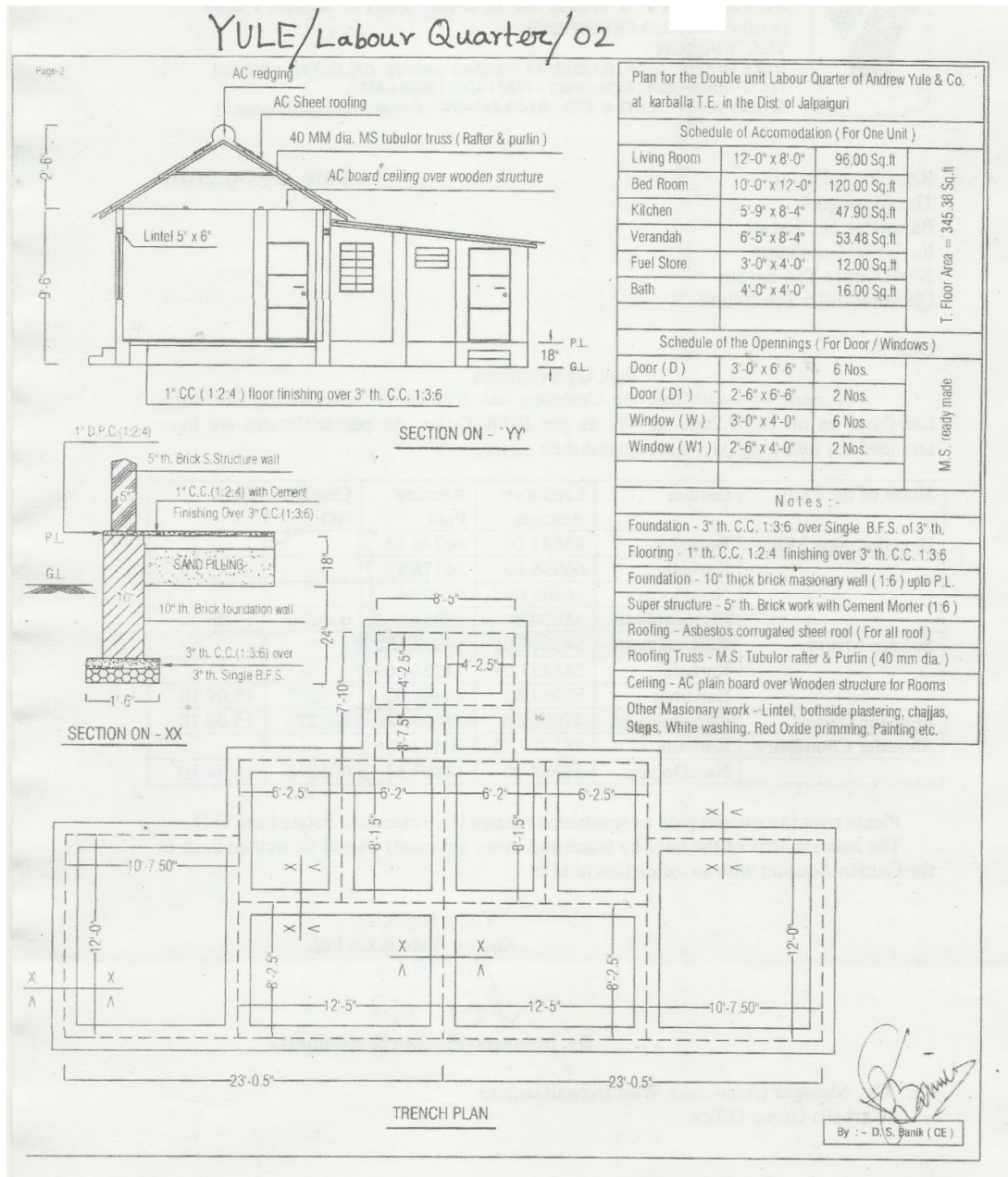

Date :

Signature of the Party with Office Seal

Annexure - III

YULE/Lavatory/01

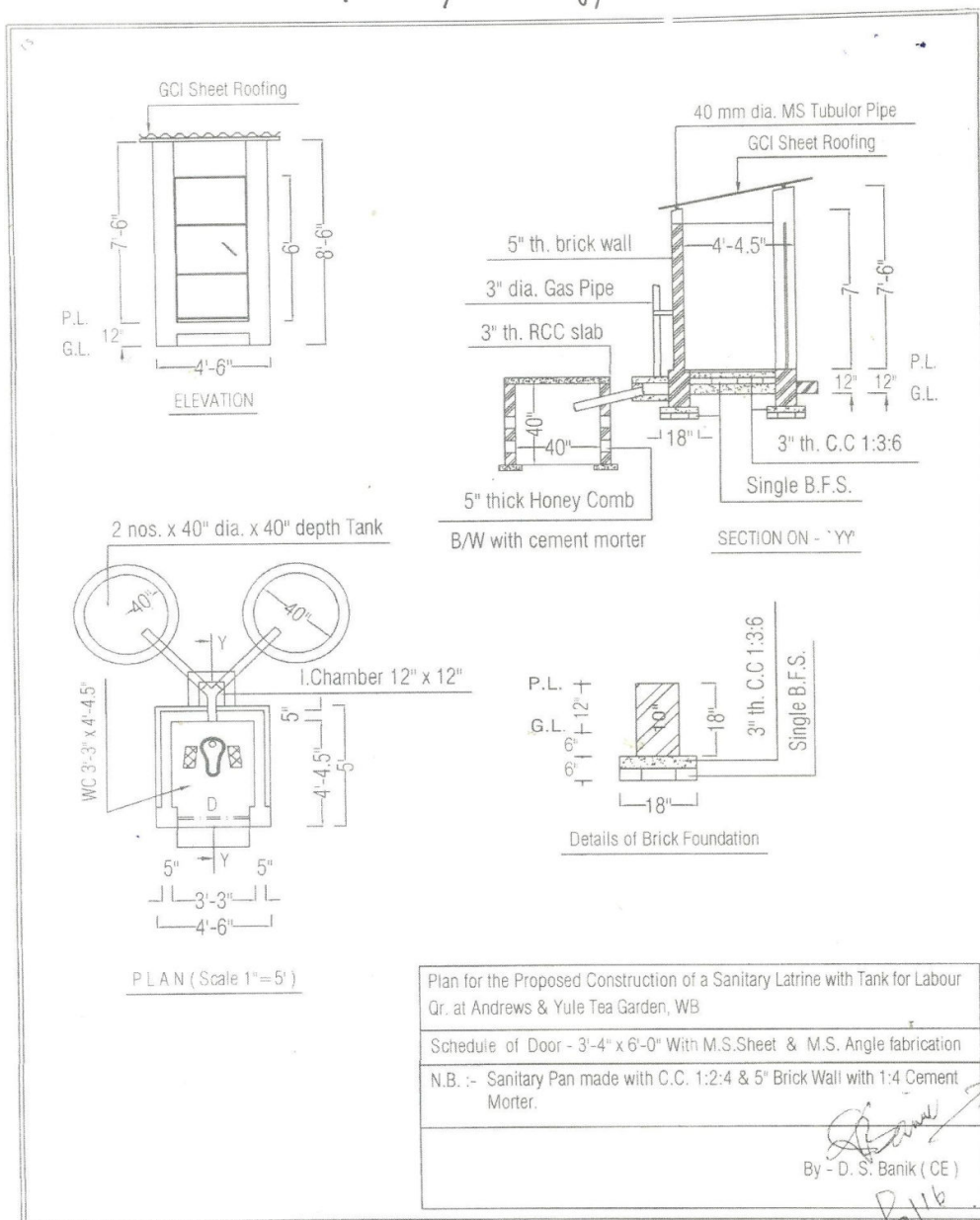

Date :

Signature of the Party with Office Seal

PART - B

Page 1

NAME OF THE WORK : - **Schedule of the works for proposed Construction of Double unit Labour Qr.**

Description of the work : - **Brick Masonary wall with AC sheet roof over MS tubular truss including the fitting of M.S. door & windows shown in the Plan**

Item No.	PARTICULARS OF WORK	QTY .	UNIT	Quoted rate	A M O U N T
1)	Earth Work in excavation of foundation trenches or drains in all sorts of soil (including mixed soil but excluding latrite soil or sandstone) including removing, spreading or stacking the spoils with in a lead of 75 m as directed. The item includes necessary trimming the sides of trenches, levelling, dressing, and ramming the bottom, bailing out water as required complete . (a) Depth of excavation not exceeding 1.50 M As per IS Code - 1200 Pt. I-1992	27.00	Cu.M.		
2)	Earth work in filling in foundation and trenches or plinth etc. in layers not exceeding 150 mm including watering and ramming etc. complete . (a) With earth obtained from excavation of foundation .	5.40	Cu.M.		
	(b) with earth obtained by fresh excavation (including cost of excavation upto 1.80 m depth from land arranged by Deptt.) Within a lead of 100 m. For plinth filling -	21.600	Cu.M.		
	(d) With carried earth arranged by the contractor within a radius beyond 5000 m but not exceeding 10 Km including cost of carried earth .	8.400	Cu.M.		
3)	Single B.F.S. of picked jhamma bricks including ramming and dressing bed to proper level and filling joints with powdered earth or local sand . As per IS Code - 1077-1992	33.80	Sq.M.		
4)	Cement Concrete (1: 3: 6) with 40 mm down graded shingles excluding shuttering. As per IS Code - 456-2000	8.010	Cu. M.		
5)	Ordinary Cement Concrete M 15 (mix 4: 2: 1) with 20 mm down graded stone chips / shingles excluding shuttering and reinforcement if any, in ground floor . (a) River Bazree - As per IS Code - 456-2000	1.670	Cu. M.		

Item No.	PARTICULARS OF WORK	QTY .	UNIT	Quoted rate	AMOUNT
6)	<p>Hire and labour charges for shuttering with centering and necessary centering and necessary staging upto 4.0 m staging upto 4.0 m using approved stout props & thick hard wood planks of approved thickness with required bracing for concrete slabs, beams, columns, lintels, curved or straight including fitting fixing and striking out after completion of works (upto roof of Ground floor) .</p> <p>(a) 25 to 30 mm thick wooden shuttering as per direction of Eng-In-Charge . As per IS Code - 4990-1993</p>	28.50	Sq.M.		
7)	<p>Reinforcement for reinforced concrete work in the all sorts of structures including distribution bars, stirrups, binders etc. including supply of rods, initial streaghtening and removal of loose rust (if necessary), cutting to requisite length, hooking and bending to correct shape, placeing in proper position and binding with 16 gauge black annealed wire at every intersection, complete as per drawing and direction .</p> <p>(a) For works in foundation, basement and upto roof of ground floor / upto 4.0 m . (i) Tor Steel / Mild steel . @ 0.80 % of (C.C. work for M15) 1.670 Cu.M = As per IS Code - 432-1982</p>	1.05	Quintel		
8)	<p>Brick work with 1 st class bricks in cement mortar (6 : 1) .</p> <p>(a) In foundation & plinth</p> <p>(b) In superstructure, ground floor As per IS Code - 2212-1991</p>	16.800 4.350	Cu. M. Cu. M.		
9)	<p>125 mm thick brick work with 1st class bricks in cement mortar (4 : 1) in ground floor .</p> <p>As per IS Code - 2250-1981</p>	96.135	Sq.M.		
10)	<p>Artificial stone in floor, dado, staircase etc. with cement concrete (4:2:1) with stone chips laid in panel as directed with topping made with ordinary or white cement (if necessary) and marble dust in propertion (2:1) including smooth finishingand rounding off corners and including application of cement slurry before flooring works using cement @ 1.75 Kg / Sq.M all complete including all materials and labour . 3 mm thick topping with ordinary cement (High polishing grinding on this item is not permitted) . (a) 20 mm thick - As per IS Code - 2571-1970</p>	32.10	Sq.M.		

Item No.	PARTICULARS OF WORK	QTY .	UNIT	Quoted rate	AMOUNT
11)	Supplying, fitting and fixing steel doors with or without integrated grills conforming to I.S. 7452 - 1973 with non friction projecting type hinges, glazing chips, lugs, locking plate, peg stays, 1.25 mm thick M.S. sheet welded kicking plates in double tray construction brass door handle with minimum 4 lever mortice lock openable with key both from inside and outside together with a locking bolt on the inside face including hoisting in position, straightening, if required fixing lugs in cement concrete (1:2:4) with stone chips 20 mm size cutting holes and mending good damages to match with existing surface complete in all respect including glazing . (b) Openable steel Door / windows - As per IS Code - 1038-1983	15.390	Sq.M.		
12)	M.S. structural works in roof trusses with Tubular sections conforming to IS: 806 - 1957 & IS :1161-1958 connected to one another with bracket, gusset, cleats as per design, direction of Engineer In Charge complete including cutting to requisite size, fabrication with necessary metal are welding conforming to IS : 816 - 1956 & IS : 9595 using electrodes of approved make and brand conforming to IS : 814 - 1957, haulage, hoisting, and erection all complete . The rate includes the cost of rolled steel section, consumables such as electrodes, gas and hire charges of all tools and plants and labour required for the work including all incidental charges such as electricity charges, labour insurance charges etc (a) For trusses spanning upto 12.0 M	5.000	Quintel		
13)	Asbestos corrugated sheet (6 mm thick) work (excluding the supporting frame work) fitted and fixed with 9.50 mm dia. J or L hook-bolt and nuts, limpet and bitumen washers and putty with 150 mm end lap & one corrugation minimum side lap complete . (i) In roof As per IS Code - 3007-(Pt.I)-1999	109.300	Sq.M		
14)	Asbestos ridging (with standard lap) fitted and fixed with necessary hook, bolts, nuts, washers etc. complete (a) Close fitting adjustable type - As per IS Code - 1626-1994(Part I-III)	16.000	R.M		
15)	Plaster (to wall, floor, ceiling etc.) with sand and cement mortar including rounding off or chamfering corners as directed and racking out joints or roughening of concrete surface including throading, nosing and drip course where necessary in G. floor .				

	(i) With (6 : 1) cement mortar (b) 20 mm thick plaster (c) 15 mm thick plaster As per IS Code - 2250-1981	220.00 130.00	Sq. M Sq. M		
16)	Neat cement punning about 1.50 mm thick in wall, Dado, window sills, floor, drain etc. Cement to be used 0.152 Cu.M per 100 Sq.M	30.00	Sq. M		
17)	Ceiling of asbestos building boards as per design fitted and fixed (excluding the supporting frame work) including necessary sal battens to cover each joint and also across at equal spaces to form panel with supply of necessary screws, nails etc complete . As per IS Code - 2096-1992	59.27	Sq.M.		
18)	Wood work in posts, post plates, rafter, battens, truss, members, purlins etc. fitted and fixed complete (Excluding the cost of bolts only, but including the cost of nails, screw etc) . (i) Other Local wood - As per IS Code - 1200 (Pt.XII)-1973	0.40	Cu.M.		
19)	Red oxide wash of approved shade including cleaning and smoothening surface thoroughly (without specific permission from the Engineer in charge this item of work must not be done on an old painted surface which has not received such red oxide wash before) . (b) One coat - As per IS Code - 102-1962	35.00	Sq.M.		
20)	Primming one coat on timber, plastered or on steel or other metal surface with synthetic enamel / oil bound primer of approved quality including smoothening surfaces by sand papering etc . (a) One coat - As per IS Code - 104-1979	27.00	Sq.M.		
21)	Painting with best quality synthetic enamel paint of approved make and brand including smoothening surface by sand papering etc. including using of approved putty etc. on the surface if necessary (a) On Timber or plaster surface (iv) Two coats (with any shade except white) (b) On steel or metal surface (iv) Two coats (with any shade except white) As per IS Code - 13607 - 1992	27.00 35.00	Sq.M. Sq.M.		

		Page 5			
22)	White washing including cleaning and smoothening surface thoroughly (5 parts of stone lime and 1 part of shell lime should be used in the finishing coat). (b) Two coats - As per IS Code - 6278-1971	340.00	Sq.M.		
23)	Electricity service connection with wiring (Follows as per WBSEDCL) including eight nos. of point where one at each Bed room, Kitchen, between bath and WC, two nos of main switch, Service bracket, twin core service wire etc. complete.	L. S.	L. S.		
Total Cost					

Date :

Signature of the Party with Office Seal

NAME OF THE WORK : - Schedule of works for the proposed Construction of Toilet with tank (Two sets) for Double unit Labour Qr.					
Description of the work : - Brick Masonary wall with GCI sheet roof over MS tubular truss including the fitting of M.S. door, two nos. circular tank shown in the Plan					
Item No	PARTICULARS OF WORK	QTY .	UNIT	Rate to be quoted	AMOUNT
1)	Earth Work in excavation of foundation trenches or drains in all sorts of soil (including mixed soil but excluding latrite soil or sandstone) including removing, spreading or stacking the spoils with in a lead of 75 m as directed. The item includes necessary trimming the sides of trenches, levelling, dressing, and ramming the bottom, bailing out water as required complete . (a) Depth of excavation not exceeding 1.50 M As per IS Code - 1200 Pt. I-1992	7.00	Cu.M.		
2)	Earth work in filling in foundation and trenches or plinth etc. in layers not exceeding 150 mm including watering and ramming etc. complete . (a) With earth obtained from excavation of foundation .	1.40	Cu.M.		
	(b) with earth obtained by fresh excavation (including cost of excavation upto 1.80 m depth from land arranged by Deptt.) Within a lead of 100 m. For plinth filling -	5.600	Cu.M.		
3)	Single B.F.S. of picked jhamma bricks including ramming and dressing bed to proper level and filling joints with powdered earth or local sand . As per IS Code - 1077-1992	7.20	Sq.M.		
4)	Cement Concrete (1: 3: 6) with 40 mm down graded shingles excluding shuttering. As per IS Code - 456-2000	0.816	Cu. M.		
5)	Ordinary Cement Concrete M 15 (mix 4: 2: 1) with 20 mm down graded stone chips / shingles excluding shuttering and reinforcement if any, in ground floor . (a) Crushers - As per IS Code - 456-2000	0.370	Cu. M.		

Item No	PARTICULARS OF WORK	QTY .	UNIT	Rate to be quoted	AMOUNT
6)	<p>Reinforcement for reinforced concrete work in the all sorts of structures including distribution bars, stirrups, binders etc. including supply of rods, initial streaghtening and removal of loose rust (if necessary), cutting to requisite length, hooking and bending to correct shape, placing in proper position and binding with 16 gauge black annealed wire at every intersection, complete as per drawing and direction .</p> <p>(a) For works in foundation, basement and upto roof of ground floor / upto 4.0 m .</p> <p>(i) Tor Steel / Mild steel .</p> <p>@ 0.80 % of (C.C. work for M15) 0.370 Cu.M =</p> <p>As per IS Code - 432-1982</p>	0.24	Quintel		
7)	<p>Brick work with 1 st class bricks in cement mortar (6 : 1) .</p> <p>(a) In foundation & plinth</p> <p>(b) In superstructure, ground floor</p> <p>As per IS Code - 2212-1991</p>	<p>1.126</p> <p>0.562</p>	<p>Cu. M.</p> <p>Cu. M.</p>		
8)	<p>125 mm thick brick work with 1st class bricks in cement mortar (4 : 1) in ground floor .</p> <p>As per IS Code - 2250-1981</p>	30.400	Sq.M.		
9)	<p>Artificial stone in floor, dado, staircase etc. with cement concrete (4:2:1) with stone chips laid in panel as directed with topping made with ordinary or white cement (if necessary) and marble dust in propertion (2:1) including smooth finishingand rounding off corners and including application of cement slurry before flooring works using cement @ 1.75 Kg / Sq.M all complete including all materials and labour .</p> <p>3 mm thick topping with ordinary cement (High polishing grinding on this item is not permitted) .</p> <p>(a) 20 mm thick -</p> <p>As per IS Code - 2571-1970</p>	2.70	Sq.M.		

Item No	PARTICULARS OF WORK	QTY .	UNIT	Rate to be quoted	AMOUNT
10)	Supplying, fitting and fixing steel doors with or without integrated grills conforming to I.S. 7452 - 1973 with non friction projecting type hinges, glazing chips, lugs, locking plate, peg stays, 1.25 mm thick M.S. sheet welded kicking plates in double tray construction brass door handle with minimum 4 lever mortice lock openable with key both from inside and outside together with a locking bolt on the inside face including hoisting in position, straightening, if required fixing lugs in cement concrete (1:2:4) with stone chips 20 mm size cutting holes and mending good damages to match with existing surface complete in all respect including glazing . (b) Openable steel Door / windows - As per IS Code - 1038-1983	3.600	Sq.M.		
11)	M.S. structural works in roof trusses with Tubular sections conforming to IS: 806 - 1957 & IS :1161-1958 connected to one another with bracket, gusset, cleats as per design, direction of Engineer In Charge complete including cutting to requisite size, fabrication with necessary metal are welding conforming to IS : 816 - 1956 & IS : 9595 using electrodes of approved make and brand conforming to IS : 814 - 1957, haulage, hoisting, and erection all complete . The rate includes the cost of rolled steel section, consumables such as electrodes, gas and hire charges of all tools and plants and labour required for the work including all incidental charges such as electricity charges, labour insurance charges etc (a) For trusses spanning upto 12.0 M	0.160	Quintel		
12)	Galvanized corrugated iron sheet work (excluding the supporting frame work) fitted and fixed with 10 mm dia. J or L hook bolts, limpet and bitumen washers and putty complete with 150 mm end lap & one corrugation minimum side lap complete. (i) In roof (b) With 0.60 mm thick sheet As per IS Code - 277-2003	9.360	Sq.M		
13)	Plaster (to wall, floor, ceiling etc.) with sand and cement mortar including rounding off or chamfering corners as directed and racking out joints or roughening of concrete surface including throading, nosing and drip course where necessary in G. floor .				

		Page-9			
	(i) With (6 : 1) cement mortar (b) 20 mm thick plaster (c) 15 mm thick plaster As per IS Code - 2250-1981	24.00 30.00	Sq. M Sq. M		
14)	Neat cement punning about 1.50 mm thick in wall, Dado, window sills, floor, drain etc. Cement to be used 0.152 Cu.M per 100 Sq.M	4.00	Sq. M		
15)	Red oxide wash of approved shade including cleaning and smoothening surface thoroughly (without specific permission from the Engineer in charge this item of work must not be done on an old painted surface which has not received such red oxide wash before) . (b) One coat - As per IS Code - 102-1962	8.00	Sq.M.		
16)	Painting with best quality synthetic enamel paint of approved make and brand including smoothening surface by sand papering etc. including using of approved putty etc. on the surface if necessary (b) On steel or metal surface (iv) Two coats (with any shade except white) As per IS Code - 13607 - 1992	8.00	Sq.M.		
17)	White washing including cleaning and smoothening surface thoroughly (5 parts of stone lime and 1 part of shell lime should be used in the finishing coat) . (b) Two coats - As per IS Code - 6278-1971	50.00	Sq.M.		
18)	Sanitary works for fitting Pan, Trap, pipe, gas pipe etc as complete	L. S.	L. S.		
Total Cost					

Date :

Signature of the Party with Office Seal